

CAMPUS MAP

Available online at this link:

<https://www.gcsu.edu/sites/default/files/documents/2024-01/Campus%20Map%201-24.pdf>

There is also an interactive map at this link: <https://libweb.gcsu.edu/campusbird/>

PARKING:

There is an interactive parking map. Unfortunately, there are no up-to-date PDF/traditional parking maps. The link to the interactive one could be posted on the conference website.

<https://map.concept3d.com/?id=941#!ce/29224?ct/0,35233,29227,29226,29231,29230,29228?s/>

TO GET TO A&S AUDITORIUM

map via Google Maps

1. Locate abbreviation A&S on the campus map. If approaching from Montgomery Street, use the first main entrance (in green) facing the Ina Dillard Russell Library. If approaching from Hancock Street, enter using the second main entrance (in green) facing the library.

2. Once inside the building, the first room on your left is the Auditorium. If you've passed the first set of restrooms, you've gone too far. If you use the blue entrance, you will have to walk left through the building until you come to another set of doors. Then the auditorium will be past the restrooms on your right just before the doors.

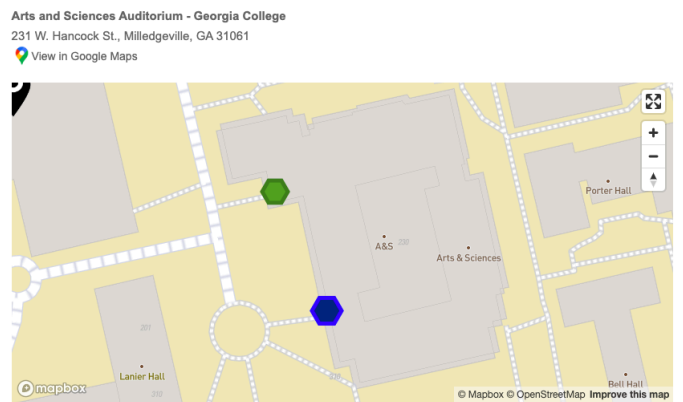

TO GET TO THE LIBRARY MUSEUM EDUCATION ROOM

(map via GCSU Library Website)

1. If you are already on campus (coming from Arts and Sciences / A&S), enter the library entrance across from A&S. Use the stairs (to the left) or elevator (to the right) to go to the second floor. Here is a map of the second floor of the library. Pass the circulation desk and keep walking until you reach a large hallway to your left. Turn down that hallway and walk until you reach the room at the end of the hallway. The Pat Peterson Museum Education Room is the room on your left.

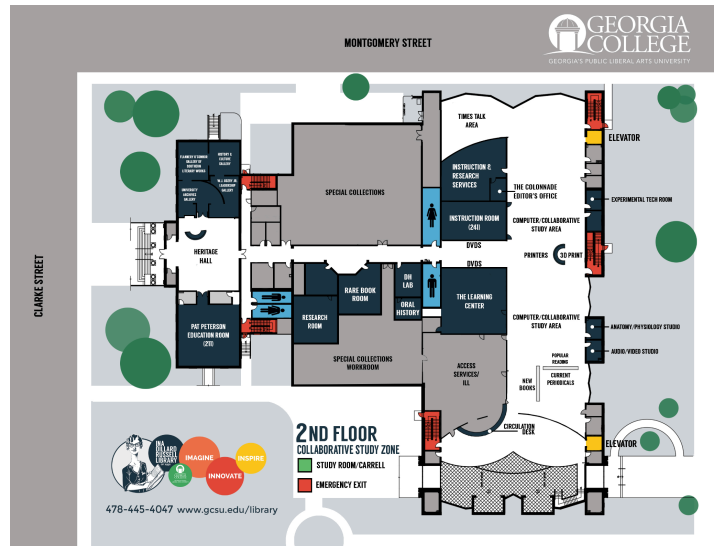

2. If you use the old entrance to the library (facing Clarke St.), then the Museum Education Room will be immediately on your right upon entry.

TO GET TO ANDALUSIA (2628 N. Columbia Street)

(map via Google Maps)

1. Directions on this map refer to how to get to Andalusia from the GCSU Main Campus (231 W. Hancock St), and are pictured here.

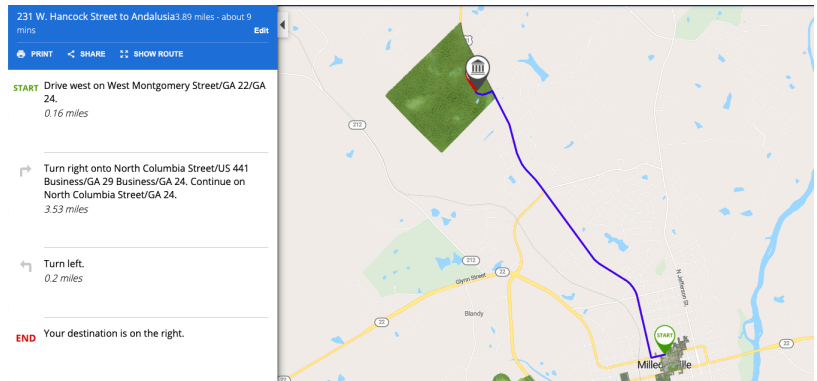

2. Andalusia is located on N. Columbia Street, access from the Super 8 and next to the Walmart.

3. Coming from the direction of Georgia College, The Comfort Suites, the Holiday Inn, the Welcome Inn, The Days Inn, the Hampton Inn, the La Quinta, and the Economy Inn, you will travel North (toward Eatonton) on N. Columbia Street and Andalusia will be on your left.

If you are staying anywhere on the lakes or at the Fairfield Inn, you will travel South (toward GCSU), and Andalusia will be on your right.

TO GET TO SACRED HEART CATHOLIC CHURCH (110 N Jefferson St NE)

1. From GCSU Front Campus, travel straight through downtown Milledgeville on Hancock Street for two blocks. Sacred Heart will be on your right, across from the Mary Vinson Memorial Library.

map via Google Maps

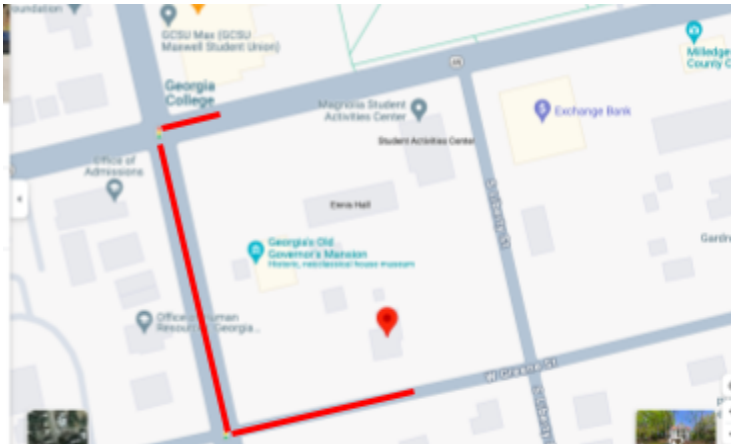

map via Google Maps

TO GET TO THE CLINE MANSION (311 W. Greene St)

1. From Georgia College Main Campus, cross Hancock Street at the diagonal crosswalk.
2. You'll see a large salmon colored building, the Georgia's Old Governor's Mansion. Walk parallel to this building until you reach the corner of Greene Street and Clarke Street. The Cline Mansion is white building with a red roof directly adjacent to the Governor's Mansion.

TO GET TO FLANNERY O'CONNOR'S GRAVE

1. Reach Memory Hill Cemetery, the main entrance of which is located at the end of Liberty Street, across from the First Baptist Church.
2. When you enter the cemetery, turn left on the first pathway, and walk about 75% of the way down. The Cline-O'Connor plot is furthest left, next to the fence that separates the cemetery from the road, and the plot is labeled with a number 1.
3. O'Connor's grave lays flat against the ground and usually has pennies on it.

It is on the East Side: Section A, Lot 39, Grave 7. This is labeled on the adjacent map as "East A".

4. You can also plug the following coordinates into Google Maps for exact walking directions to the Cline/O'Connor plot: Latitude: 33.07631756, Longitude: -83.22838698

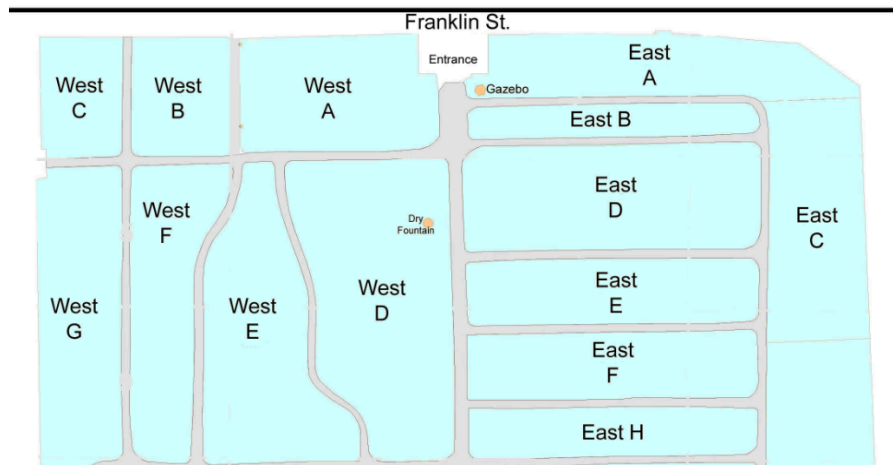

Map via Friends of Cemeteries Website - Memory Hill

MAP OF O'CONNOR SITES OF INTEREST, VIA VISIT MILLEDGEVILLE

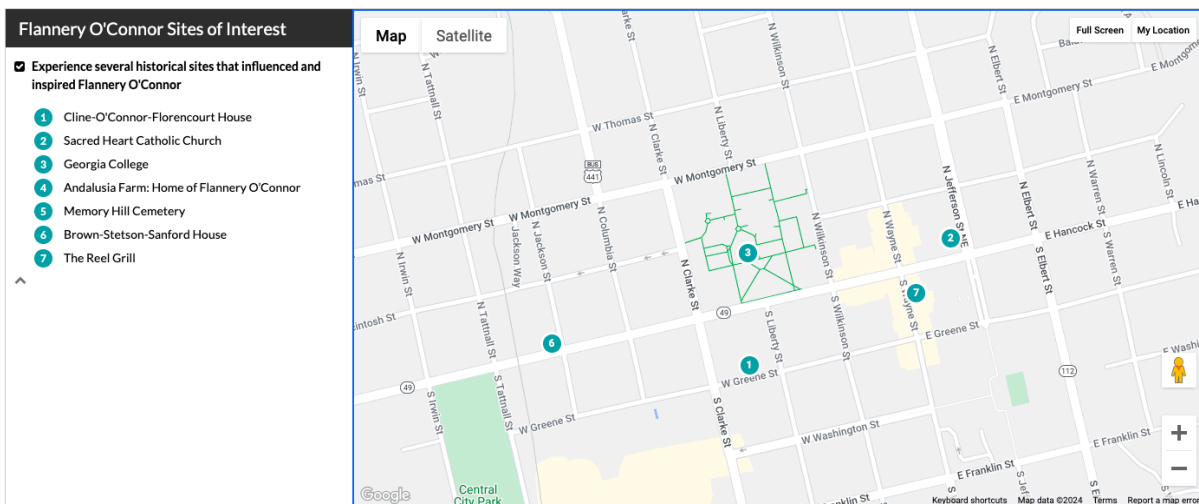

"When in Rome, do as you done in Milledgeville."